

CHERRINGTON CORPORATE CENTER

200 Corporate Center Drive, Suite 220 - Coraopolis, PA 15108

**SUBLEASE SPACE
AVAILABLE**



- 10,165 SF Available
- Term through June 30, 2021
- Plug and play opportunity - furniture can be made available
- Within walking distance to new Amenity Center
- Willing to subdivide



CONTACT

Michael Connor

mconnor@HannaLWE.com

412.261.2200

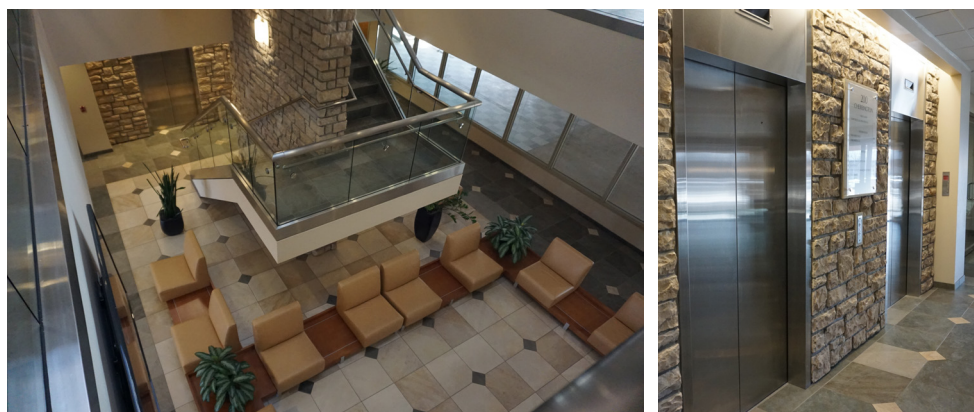

All information furnished regarding property for sale, rental or financing is from sources deemed reliable. No representation is made as to the accuracy thereof, and it is submitted subject to errors, omissions, change of price, rental, or other conditions, prior sale lease, financing or withdrawal without notice. Hanna Langholz Wilson Ellis will make no representation, and assume no obligation, regarding the presence or absence of toxic or hazardous waste or substances or other undesirable material on or about the property.

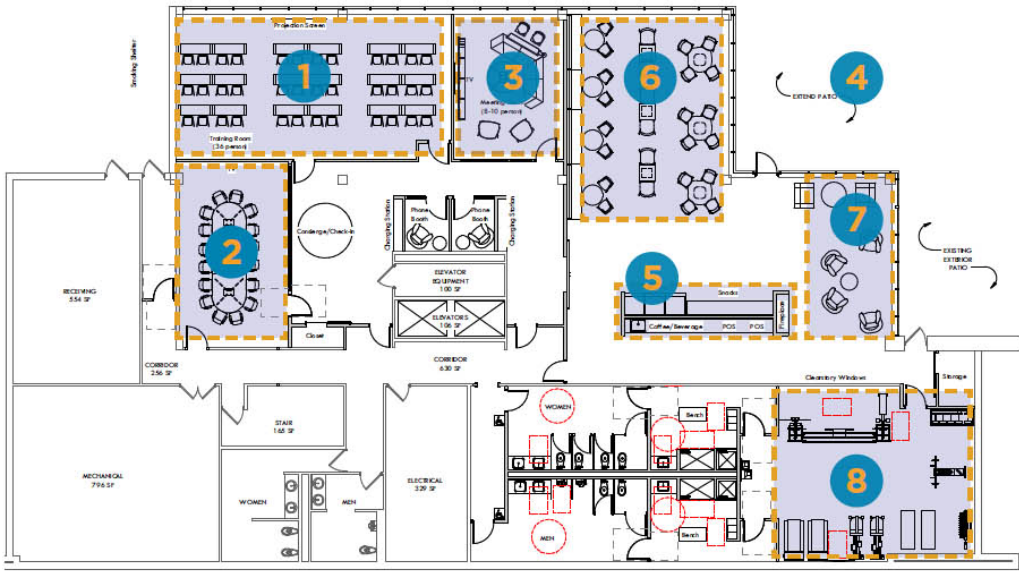

- 1 LARGE CONFERENCE/MEETING ROOM
- 2 SMALL MEETING ROOM
- 3 BREAKOUT LOUNGE
- 4 OUTDOOR SPACE
- 5 COFFEE BAR
- 6 CAFETERIA/KITCHEN
- 7 TENANT LOUNGE
- 8 FITNESS CENTER



Michael Connor
 mconnor@HannaLWE.com

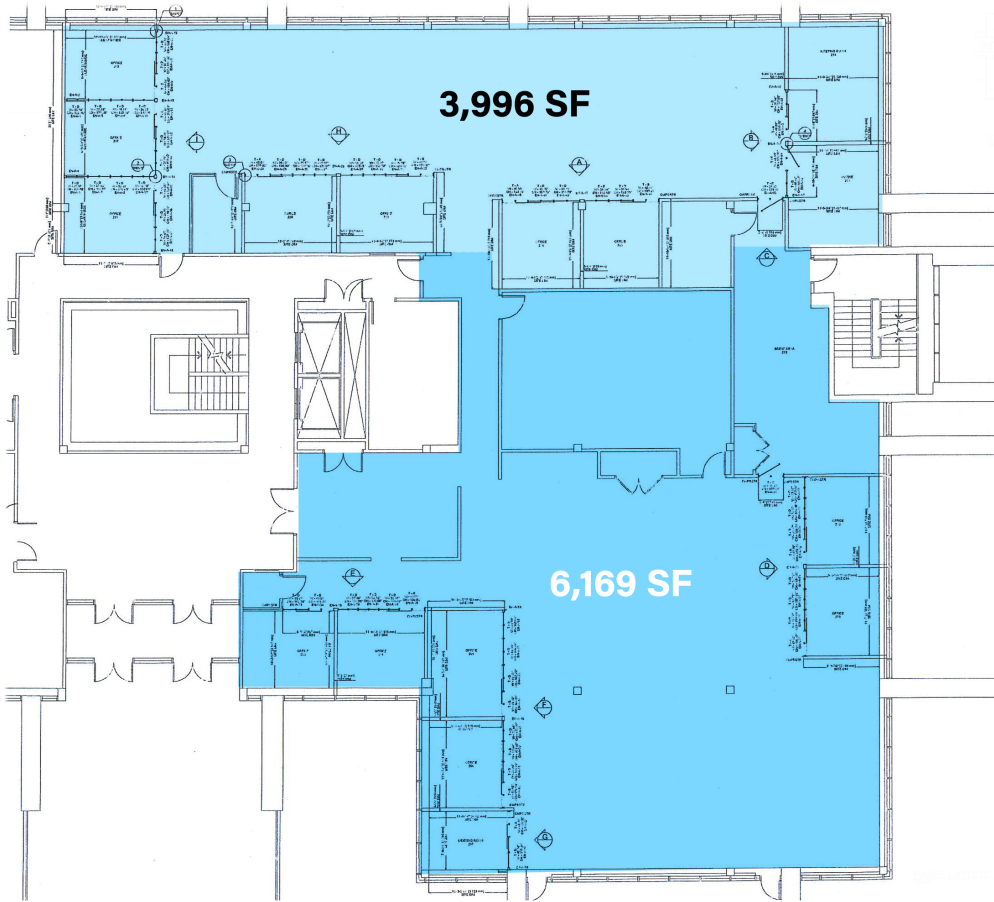

CHERRINGTON CORPORATE CENTER
 200 Corporate Center Drive, Suite 220 - Coraopolis, PA 15108

